

**APPLICATIONS:**

Used to produce a pneumatic output signal when the monitored differential pressure rises above the set differential pressure. The pneumatic signal source is isolated from the monitored pressure.

**OPERATION:**

The 30 PG PDDA-S Pilot can be considered to be an direct multiplier. Each 1 psig change in Controlled Pressure results in a change in Output pressure of 6 psig.

**SUPPLY PRESSURE:**

30 psig.

**PRESSURE RANGE:**

5 psig to 280 psig

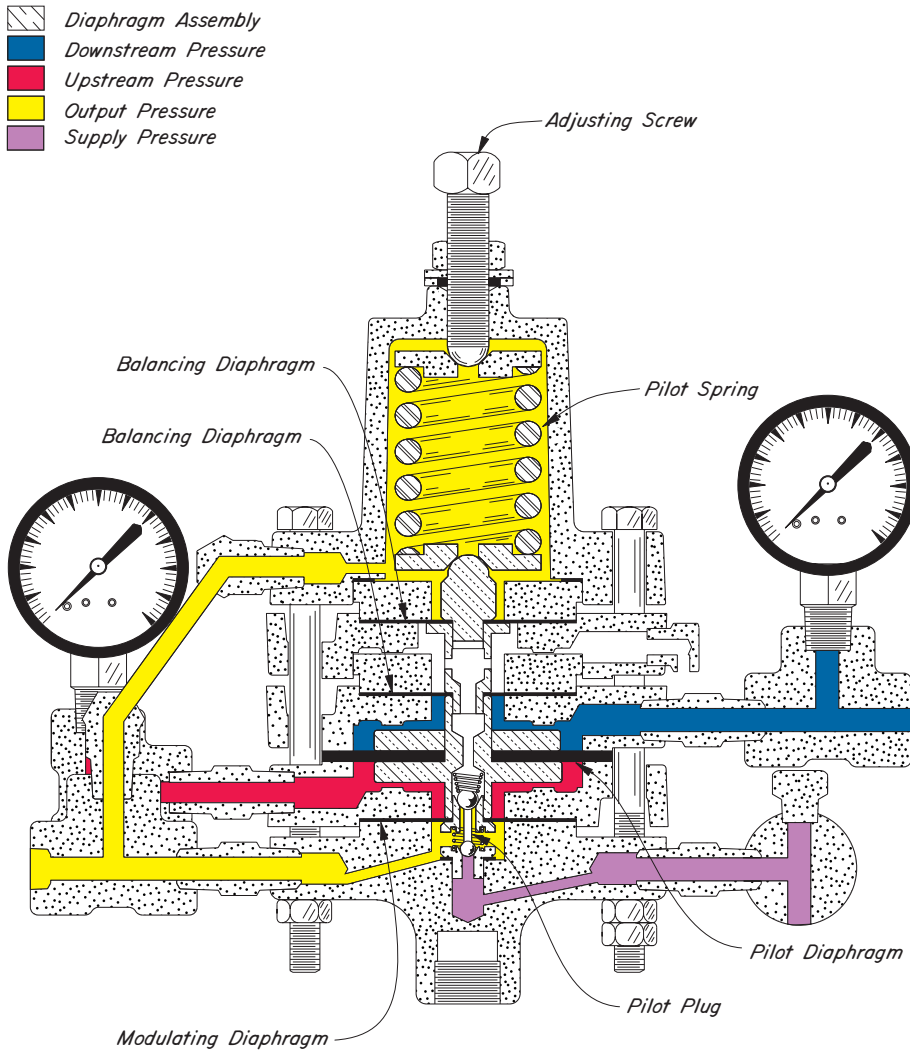

30 PG PDDA-S  
 STEEL  
 300 lbs. W.P.

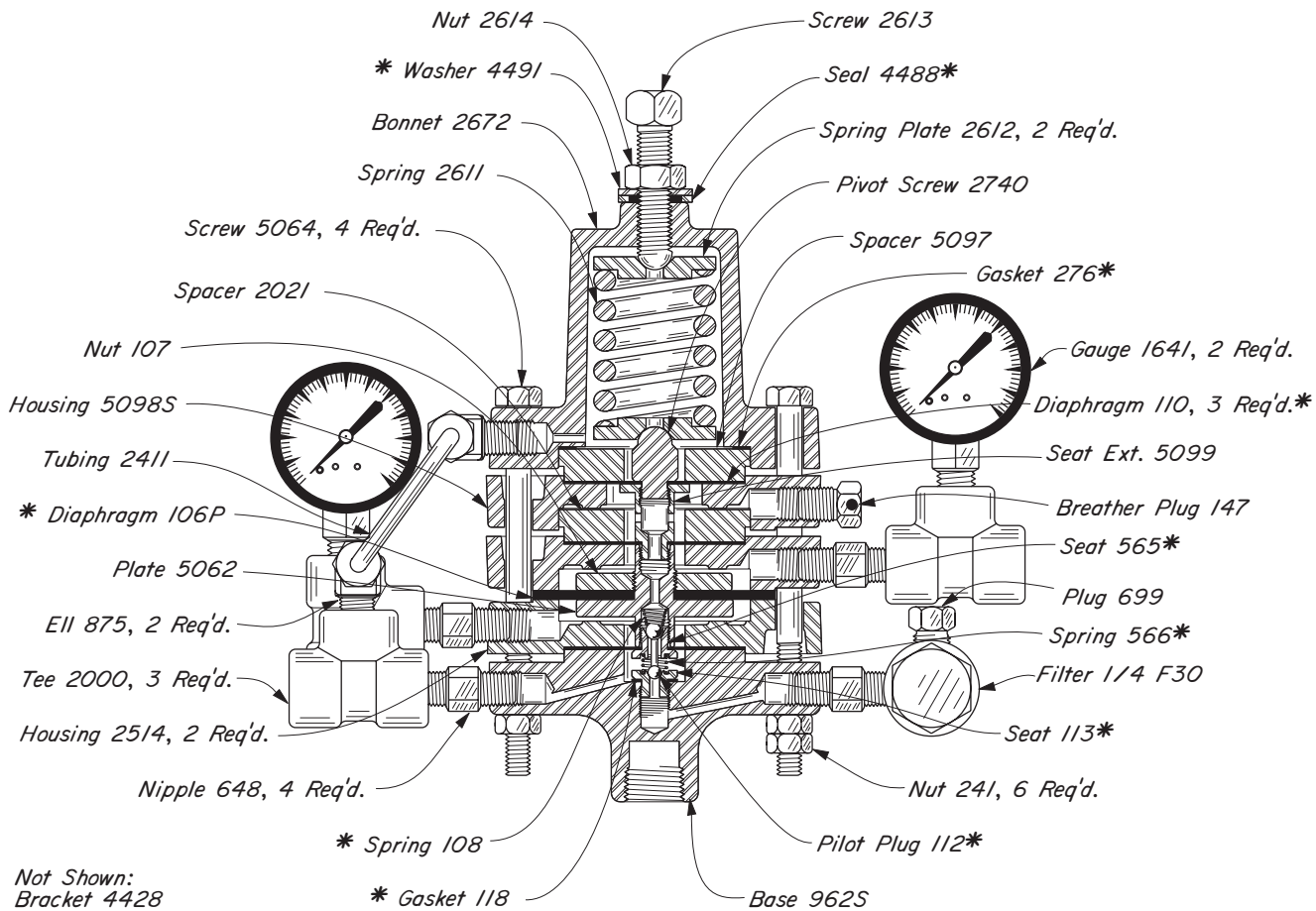

**PILOTS AVAILABLE:**

CAT. NO.	PILOTS	DES. PRESS.	OPER. PRESS.
AHV	30 PG PDDA-S	300	300

\*These are recommended spare parts and are stocked as repair kits. To order repair kit, specify: "30 PG PDDA-S Repair Kit, RSQ"